



## GOUPILLES CYLINDRIQUES RECTIFIÉES

DIN 6325 - ISO 8734 - NFE 27475

GROUND DOWEL PINS DIN 6325 - ISO 8734 - NFE 27475

> Désignation : Goupilles cylindriques DIN6325 D x L.

Description: Dowel pins DIN6325 D x L.

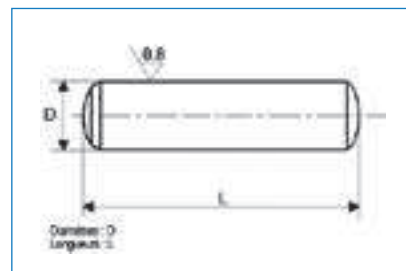

**Matière : Acier trempé revenu pour dureté 58-62 HRC**

Material: Steel hardened and tempered for hardness 58-62 HRC

| D<br>m6 | Longueur<br>Length |   |   |   |    |    |    |    |    |    |    |    |    |    |    |    |    |    |    |    |    |    |    |    |     |     |     |     |     |     |     |     |     |     |     |     |
|---------|--------------------|---|---|---|----|----|----|----|----|----|----|----|----|----|----|----|----|----|----|----|----|----|----|----|-----|-----|-----|-----|-----|-----|-----|-----|-----|-----|-----|-----|
| 1       | 4                  | 5 | 6 | 8 | 10 | 12 | 14 | 16 |    |    |    |    |    |    |    |    |    |    |    |    |    |    |    |    |     |     |     |     |     |     |     |     |     |     |     |     |
| 1,5     | 4                  | 5 | 6 | 8 | 10 | 12 | 14 | 16 | 18 | 20 | 22 | 24 | 26 | 28 | 30 |    |    |    |    |    |    |    |    |    |     |     |     |     |     |     |     |     |     |     |     |     |
| 2       | 4                  | 5 | 6 | 8 | 10 | 12 | 14 | 16 | 18 | 20 | 22 | 24 | 26 | 28 | 30 | 32 | 36 | 40 | 45 |    |    |    |    |    |     |     |     |     |     |     |     |     |     |     |     |     |
| 2,5     | 4                  | 5 | 6 | 8 | 10 | 12 | 14 | 16 | 18 | 20 | 22 | 24 | 26 | 28 | 30 | 32 | 36 | 40 | 45 | 50 |    |    |    |    |     |     |     |     |     |     |     |     |     |     |     |     |
| 3       |                    | 5 | 6 | 8 | 10 | 12 | 14 | 16 | 18 | 20 | 22 | 24 | 26 | 28 | 30 | 32 | 36 | 40 | 45 | 50 | 55 | 60 |    |    |     |     |     |     |     |     |     |     |     |     |     |     |
| 4       |                    |   | 6 | 8 | 10 | 12 | 14 | 16 | 18 | 20 | 22 | 24 | 26 | 28 | 30 | 32 | 36 | 40 | 45 | 50 | 55 | 60 | 70 | 80 |     |     |     |     | 150 | 160 | 180 |     |     |     |     |     |
| 5       |                    |   |   | 8 | 10 | 12 | 14 | 16 | 18 | 20 | 22 | 24 | 26 | 28 | 30 | 32 | 36 | 40 | 45 | 50 | 55 | 60 | 70 | 80 | 90  | 100 |     |     |     | 150 | 160 | 200 |     |     |     |     |
| 6       |                    |   |   |   | 10 | 12 | 14 | 16 | 18 | 20 | 22 | 24 | 26 | 28 | 30 | 32 | 36 | 40 | 45 | 50 | 55 | 60 | 70 | 80 | 90  | 100 |     |     |     | 150 | 160 | 180 |     |     |     |     |
| 8       |                    |   |   |   | 10 | 12 | 14 | 16 | 18 | 20 | 22 | 24 | 26 | 28 | 30 | 32 | 36 | 40 | 45 | 50 | 55 | 60 | 70 | 80 | 90  | 100 | 110 | 120 |     |     | 150 | 160 | 180 | 200 |     |     |
| 10      |                    |   |   |   |    | 14 | 16 | 18 | 20 | 22 | 24 | 26 | 28 | 30 | 32 | 36 | 40 | 45 | 50 | 55 | 60 | 70 | 80 | 90 | 100 | 110 | 120 | 130 | 140 | 150 | 160 | 150 | 160 | 180 | 200 |     |
| 12      |                    |   |   |   |    |    | 16 | 18 | 20 | 22 | 24 | 26 | 28 | 30 | 32 | 36 | 40 | 45 | 50 | 55 | 60 | 70 | 80 | 90 | 100 | 110 | 120 | 130 | 140 | 150 | 160 | 150 | 160 | 180 | 200 |     |
| 14      |                    |   |   |   |    |    |    |    | 20 | 22 | 24 | 26 | 28 | 30 | 32 | 36 | 40 | 45 | 50 | 55 | 60 | 70 | 80 | 90 | 100 | 110 | 120 | 130 | 140 | 150 | 160 | 150 | 160 | 180 | 200 |     |
| 16      |                    |   |   |   |    |    |    |    |    |    | 24 | 26 | 28 | 30 | 32 | 36 | 40 | 45 | 50 | 55 | 60 | 70 | 80 | 90 | 100 | 110 | 120 | 130 | 140 | 150 | 160 |     |     |     |     |     |
| 18      |                    |   |   |   |    |    |    |    |    |    |    |    |    | 30 | 32 | 36 | 40 | 45 | 50 | 55 | 60 | 70 | 80 | 90 | 100 | 110 | 120 | 130 | 140 | 150 | 160 |     |     |     |     |     |
| 20      |                    |   |   |   |    |    |    |    |    |    |    |    |    |    | 30 | 32 | 36 | 40 | 45 | 50 | 55 | 60 | 70 | 80 | 90  | 100 | 110 | 120 | 130 | 140 | 150 | 160 | 150 | 160 | 180 | 200 |
| 25      |                    |   |   |   |    |    |    |    |    |    |    |    |    |    |    |    |    |    | 50 | 55 | 60 | 70 | 80 | 90 | 100 | 110 | 120 | 130 | 140 | 150 | 160 | 150 | 160 | 180 | 200 |     |
| 30      |                    |   |   |   |    |    |    |    |    |    |    |    |    |    |    |    |    |    |    |    | 50 | 55 | 60 | 70 | 80  | 90  | 100 | 110 | 120 | 130 | 140 | 150 | 160 |     |     |     |

Boîtes assortiments goupilles voir p.30  
Boxed set of pins, see p.30

### SUR DEMANDE

On request

> Dimensions et tolérances spéciales.

Other tolerances and dimensions.

> Matières spéciales notamment en inox.

Special materials, particularly stainless steel.